

PHILIPS

100 Craftway Dr.
Littlestown, Pennsylvania 17340-0128
Phone: (717) 359-7131

INSTALLATION INSTRUCTIONS: BL-25/26/27/28/30/31/32/33

Safety, Warnings and Suggestions

- 1 *Care* should be taken not to position fixtures in locations where bare skin can come into contact with the potentially high temperatures on the lens.
- 2 *Make* sure that electrical power is disconnected before any work is performed.
- 3 *All* gaskets and sealing surfaces must be kept clean during installation.
- 4 *All* wiring and installation should meet local, state and national electrical codes.
- 5 *Install* correct lamp type and wattage.

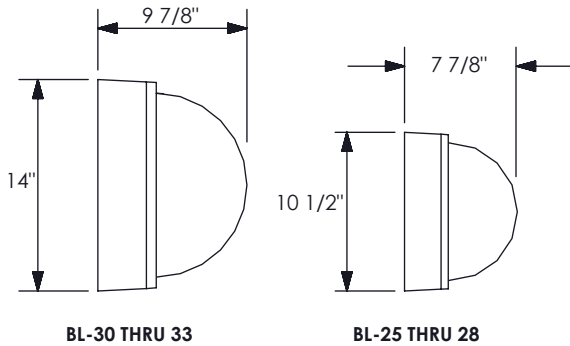

BL-30 THRU 33

BL-25 THRU 28

TYPICAL FIXTURE DIMENSIONS

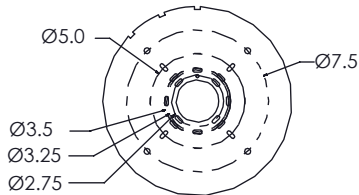

BL-25 THRU 28
MOUNTING DETAIL

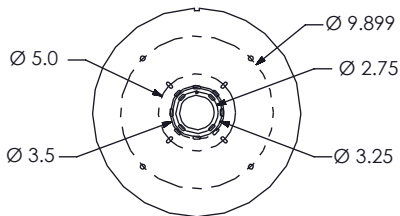

BL-30 THRU 33
MOUNTING DETAIL

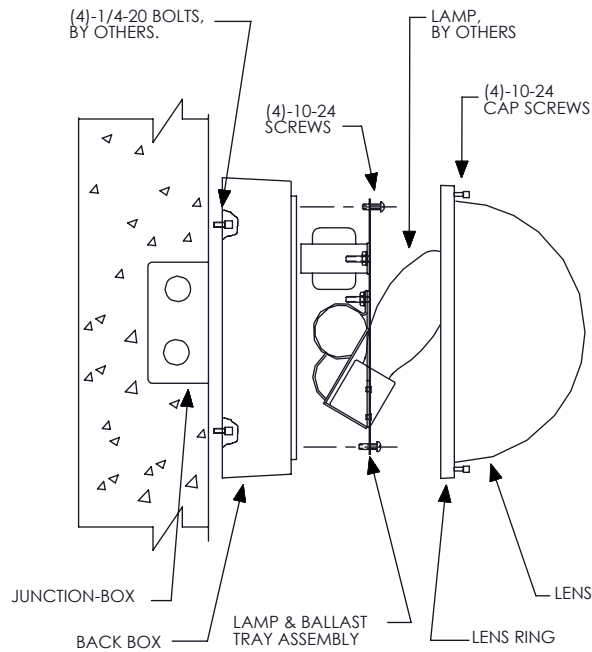

TYPICAL WALL INSTALLATION

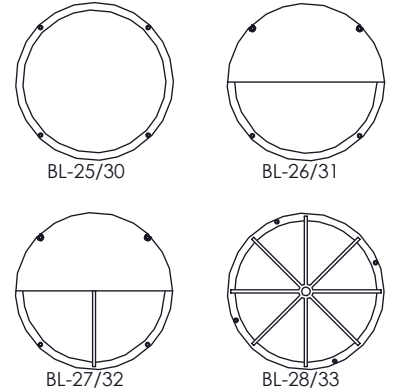

1. Remove the fixture from the box. Remove the lens and lens ring by loosening (4)-10-24 cap screws. Remove the ballast tray assembly by loosening (4)-10-24 screws.

2. Secure the back box to the wall with (4)-1/4-20 bolts or to the junction box with 8-32 screws, hardware by others. Make power and ground connection using UL approved connectors at the Junction-box (J-box by others). Reinstall the ballast tray with the (4)-10-24 screws provided

3. (LAMP INSTALLATION)
Install the correct lamp type and wattage. Reinstall the lens and lens ring. Tighten the (4)-10-24 cap screws.

