

Landscape Areas

Sign Lighting

Tree Lighting

Building Accent Lighting



BABY BELERO

FL-61 with EEBH

Specifications



Certifications ETL and CETL listed for wet location, direct burial, and concrete pour. Also meets IP65 standard.

Fixture Housing Die cast aluminum. 1/2" NPS adjustable die cast aluminum knuckle with strength support against vertical displacement. The knuckle provides 135° vertical and 360° horizontal adjustability. Stainless steel screws are used as standard.

Lens Clear tempered 1/8" thick, sealed to lens frame with silicone gasket.

Lens Frame Die cast aluminum minimum thickness of 1/8" attached to fixture housing with four captive stainless steel 6-32 socket cap screws.

Lamp Holder Porcelain 4KV pulse rated for HID and Incandescent lamp source.

Options Cast aluminum ballast housings (EEBH, WMR, WMS). Composite Ballast Housing (CBH). Compression molded Rhinolite™ composite material, structurally reinforced with glass fibers. Glass Color Filter (GF), Visor (MV), Internal Hex Cell Louver (HL).

Finish BK-BZ-WH-GR-GY-NA thermoset polyester powdercoat which is electrostatically applied and bonded by heat fusion thermosetting. CC available upon request.

Safety Caution: Care should be taken when specifying fixtures for use in pedestrian areas to avoid problems that may be caused by high lens temperatures. Consult factory for more information.

Warning Caution: Care should be taken not to install in-ground ballast housings in areas where water can stand for prolonged periods of time. Sufficient drainage must be provided to avoid problems. Consult factory for more information.

Warning Caution: Care should be taken in the placement of landscape floodlights. Avoid areas where landscape maintenance equipment such as lawn mowers may come into direct contact and damage the fixture.

PROJECT
FIXTURE TYPE
CATALOG#

FL-61 BELERO

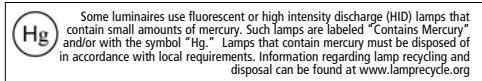

Product Order Guide

Consult Belero Application Brochure For More Options

Series	Max Watts	Lamp Type	Voltage ¹	Finish ¹	Options
FL-61	50INC	PAR 20	120	BK Black	RCBH Remote Composite Ballast Housing
	39MH	PAR 20	120-277	BZ Bronze	CBH Composite Ballast Housing
	39MH	T4-GU6.5 SPT & FLD	120-277	WH White	EEBH ^{2,3,4} Electronic Elliptical Ballast Housing
	50LV	MR16	12/120	GR Green	
				NA Natl Alum	WMR Wall Mount Recessed
				GY Gray	WMS ² Wall Mount Surface
				CC Custom	HL Internal Hex Cell Louver
					GF Glass Color Filter- (Specify Color)
					UD ² Up/Down Mount
					SP Straight Post
					STNM Stanchion Mount
					JBR ^{2,5} Junction Box Round
					JBS ⁵ Junction Box Square
					JBRTM ⁵ Tree Mount Junction Box
					LP ⁵ Low Post (Plastic)
					PL 90° Post
					DPL 90° Double Post
					CP Curve Post
					SA Straight Arm
					CA Curve Arm
					MV Medium Visor

LED's available, consult factory

- 1 Consult factory for other colors and voltages.
- 2 Specify Junction Box Mounting or Surface Conduit Connection.
- 3 4" Octagonal or 2"x 4" J-box for Junction Mounting.
- 4 Specify position (N,S,E,W) of Conduit Entry for Surface Conduit Connection.
- 5 Remote ballast required.

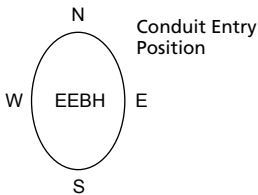

Example: FL-61-39MH-120-PAR20-V-BK-EEBH

Luminaire Dimensions

Luminaire	A		B		C		D		E		Weight	
	Inch	mm	Inch	mm	Inch	mm	Inch	mm	Inch	mm	lbs.	kg
FL-61	8.10	206	4.50	114	7.00	178	n/a	n/a	n/a	n/a	3.00	1.3
FL-61-WWR	n/a	n/a	3.50	89	6.40	163	7.00	178	n/a	n/a	24.00	10.8
FL-61-WMS	10.10	256	3.50	89	6.40	163	7.00	178	n/a	n/a	24.00	10.8
FL-61-UD	6.00	152	3.50	89	10.40	264	7.00	178	17.00	432	18.00	8.1
FL-61-EEBH	6.00	152	3.50	89	9.50	241	8.00	203	5.50	141	12.00	5.4

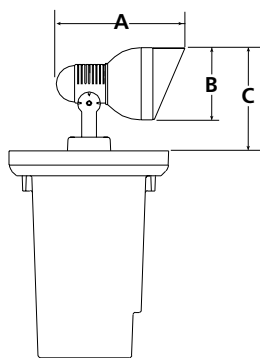

CBH

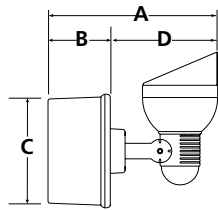

WMS/WMR

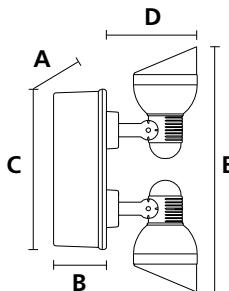

UD

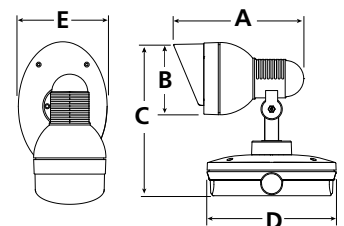

EEBH

Note: dimensions are shown with optional visor